

SWING GATE BARRIER

INDUSTRIAL PERSONAL CONTROL GATE



MODEL

ESW-300
SINGLE WING

ESW-320
DOUBLE WING

SPECIFICATION

SIZE :

1200 x 280 x 960 mm.

UNLOCK TIME :

0.4 second

PASS RATE :

32 person / min.

INPUT VOLTAGE :

110V. ~ 240V.

MOTOR :

Taibang 40K 20W.

MATERIAL :

1.0mm SUS304 400HL

SENSOR :

G-Tec 4 Pairs

POWER SUPPLY :

Fujia 24V 120Watts

NET WEIGHT :

50 KG. for ESW-300

58 KG. for ESW-320



PRODUCT SIZE & DIMENSION

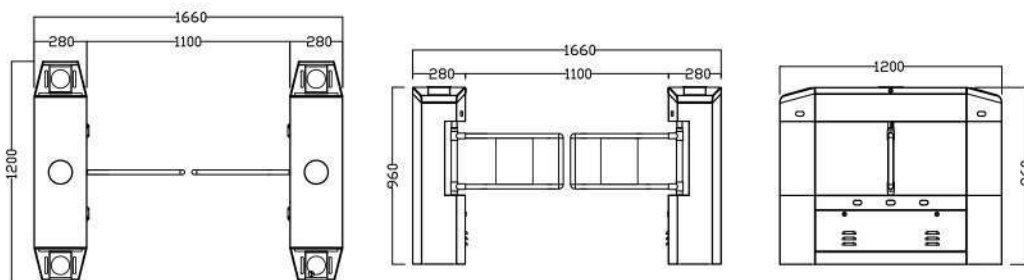

GET MORE DETAIL

www.entranceautogate.com

